

Tripod Drill Machine

Model: TRI-DR

Portable Glass Tripod Drill

Designed for professional glass fabrication and field service applications, the PST Portable Glass Tripod Drill delivers accurate, controlled hole drilling in glass using diamond, steel, brass tube, spearpoint, and prismatic drills. Its self-feeding design, precision depth controls, and rugged construction provide superior drilling accuracy while minimizing glass chipping, operator fatigue, and maintenance requirements.

Features and Specifications:

- Compatible with diamond, steel, brass tube, spearpoint, and prismatic drills.
- Operates on standard 110V electrical service.
- Industrial-grade 6-amp drill motor with ball thrust bearings.
- Variable speed control from 0–1,400 RPM.
- 1/2" chuck capacity accommodates hole drills up to 6" diameter.
- Dual adjustment system provides both rapid and micro depth adjustments for precise drilling control.
- Self-drilling design reduces operator-applied pressure and improves consistency.
- Ergonomic compound-action handle.
- Non-skid rubber leg caps improve stability and reduce vibration during operation.
- Integrated carrying/tote handle for easy transport and field use.
- Rugged construction designed to withstand daily shop and service vehicle environments.





Advantages of the PST Tripod Drill Design

- High-precision drilling system engineered for superior hole location accuracy.
- Smooth-operating design eliminates the friction and binding commonly associated with guide-way systems.
- Reduced maintenance requirements with no ongoing alignment adjustments.
- Durable construction designed to tolerate typical field-service handling and transportation.
- Engineered for extended service life and long-term reliability.
- Factory-direct manufacturing and support.

Ideal Applications

- Glass fabrication shops
- Field glazing service work
- Shower door installations
- Architectural glass drilling
- Custom glass and mirror fabrication
- Production and maintenance environments requiring accurate hole drilling in glass surfaces

TRIPOD DRILL MACHINE			
Manufacturers	Perfect Score Technologies	Somaca	Baldwin Machine Works
			
Model	TRI-DR	Somaca	BM3
Power	110 Volt	110 Volt	110 Volt
Motor Size	6 Amp Motor	4 Amp Motor	4 Amp Motor
Chuck Size	1/2 Inch	3/8 Inch	3/8 Inch
Max Drill Size	6 Inch Diameter	6 Inch Diameter	5 Inch Diameter
Variable Speed	0-1400 RPM (Increased Drill Feed Rate)	0-1300 RPM	0-1300 RPM
Fixed Speed	All models variable	All models variable	Some models are 2 speed only
Depth Adjustment Presets	Standard	Standard	Standard
Guide Type	Linear shaft ways coupled w/ linear slides	Double Sealed Ball Bearing	Double Sealed Ball Bearing
Motor Mounting	3 point adjustment with bracket alignment	3 point adjustment screws	3 point adjustment screws
Drill Accuracy	Superiority - Linear ways and slides	Average	Average
Carrying Lift Handle	Yes	No	No
Replacement Parts	Yes	Yes	Unknown

Related Items

Rev. 6/2026

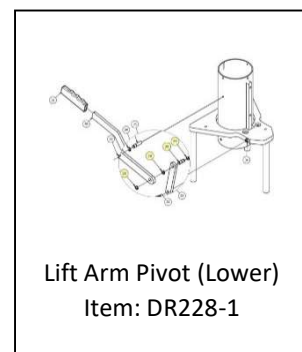
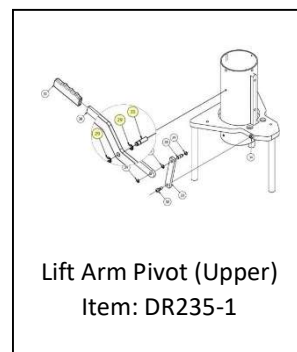
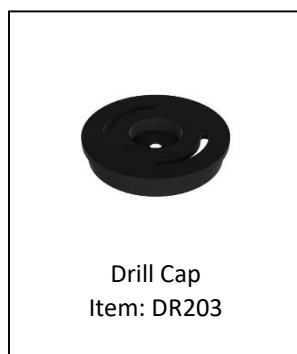
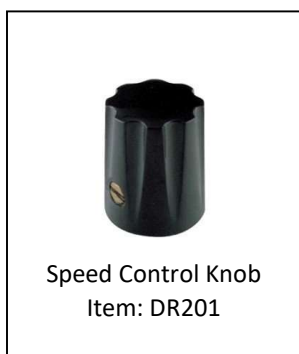

Rev. 6/2026